

Where Dreams Find Their Address





The Story behind the design "Where form meets flow"

A harmonious blend of contemporary design and vernacular charm, this residence features earthy terracotta tones, exposed brickwork, and handcrafted jali screens that echo Mumbai's architectural heritage. Lush balcony planters bring nature into everyday living. Striking yet grounded, the design balances tradition with modernity in the city's evolving skyline.



Artist Impression



Artist Impression

Designed to welcome,
built to inspire

Grand Entrance Lobby

Dreams Built Into Every Detail

Armaan is a rare creation in Santacruz West, conceived by one of the city's reputed developers Poonam Group.

Thoughtfully designed and passionately crafted, it embodies elegance, exclusivity, and a deep sense of belonging.

Every residence at Armaan is a statement of refined living - with timeless design, luxurious finishes, and spaces that celebrate light, comfort, and harmony.

Set in the heart of Santacruz West, Armaan offers you not just a home, but an address that mirrors your aspirations and accomplishments.



Project Highlights:

- 13 habitable floors
- One residence per floor
- Luxurious 2 & 3 bedroom residences with private balconies
- Vastu compliant, homes ensuring harmony and positive energy flow
- Thoughtfully designed for modern living, exclusivity and privacy

Apartment Specifications:

- 11 foot slab to slab height on every floor
- Column free design for maximized, unobstructed living spaces
- Dedicated staff toilet for each flat for added convenience
- Video door phone, Intercom & digital door locks for enhanced security

Shape Your Day with Wellness and Style

- Equipped fitness centre
- Society office
- 24 hrs CCTV surveillance system for common areas



Artist Impression



Artist Impression



Artist Impression

Indulge in Spaces
That Breathe
Opulence



Artist Impression

Thoughtfully Planned. Perfectly Crafted



3 BHK

Elegantly Designed, Beautifully Balanced



2 BHK

Typical Floor Plan
3 BHK - 8th to 14th Floor

Sr.no	Description	Sizes (Indicative)	Area (in SQ.FT)	Area (in SQ.MT)
1	LIVING & DINING	17'4" x 17'4"	300.33	27.90
2	BALCONY	17'4" x 4'5"	76.60	7.12
3	POWER TOILET	4'6" x 4'6"	20.25	1.88
4	KITCHEN	10'9" x 9'9"	104.81	9.74
5	DRY BALCONY	10'9" x 3'6"	37.63	3.50
6	PASSAGE	19'10" x 3.6"	69.41	6.45
7	BEDROOM - 1	10'7" x 13'10"	146.32	13.59
8	TOILET - 1	4'6" x 8'10"	39.74	3.69
9	BEDROOM - 2	13'5" x 11'0" 3'4" x 3'4"	158.71	14.74
10	TOILET - 2	8'6" x 4'8"	39.70	3.69
11	BEDROOM - 3	13'5" x 11'0" 3'4" x 5'3"	165.10	15.34
12	TOILET - 3	8'6" x 6'0"	51.00	4.74
13	INTERNAL WALLS	-	65.01	6.04
	RERA AREA		1275	118.41



Note: The information above is indicative and subjective to regulation. Developer reserves the right to make changes or improvements without prior notice or obligation. The plan is not for sale.

Typical Floor Plan
2 BHK - 1st, 6th & 7th Floor

Sr.no	Description	Sizes (Indicative)	Area (in SQ.FT)	Area (in SQ.MT)
1	LIVING	10'3" x 17'10"	182.76	16.98
2	DINING	8'4" x 8'4"	69.39	6.45
3	KITCHEN	7'10" x 9'0"	70.47	6.55
4	BEDROOM - 1	13'5" x 11'0"	147.62	13.71
5	TOILET - 1	8'6" x 4'8"	39.70	3.69
6	BEDROOM - 2	13'5" x 11'0" 3'4" x 5'3"	165.10	15.34
7	TOILET - 2	8'6" x 6'0"	51.00	4.74
8	PASSAGE	3'4" x 6'11"	23.04	2.14
9	INTERNAL WALLS	-	38.10	3.54
		RERA AREA	787	73.13



A Place to Meditate, Mingle, and make Memories

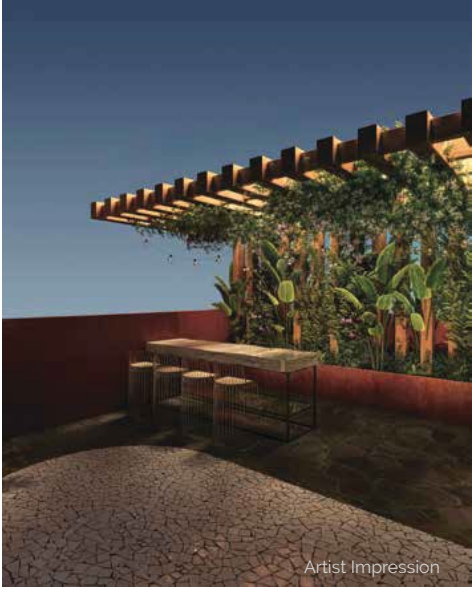

Artist Impression



Artist Impression

- Sky garden lounge with sit-outs
- Children's play area
- Yoga meditation zone

Your Address of Architectural Pride

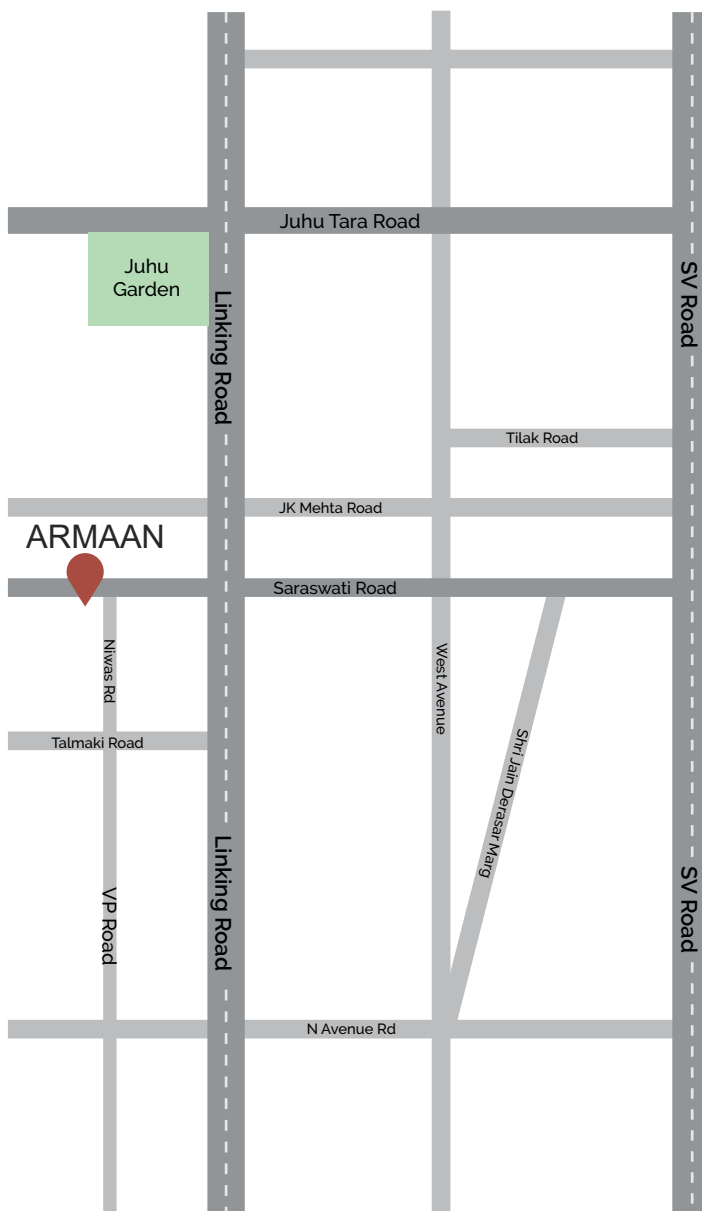

Retail, Entertainment & Leisure:

5–10 min drive

- Linking Road High Street
- PVR Lido Cinema
- Soho House
- Gold Cinema Milan Subway
- Saraswat Colony Park
- Lions Juhu Garden
- Rajesh Khanna Park
- Khar Gymkhana

Connectivity: 5–15 min drive

- Santacruz West Station
- Santacruz Metro Station
- Khar West Railway Station

Hospitals: 5–10 min drive

- Nanavati Max Super Speciality Hospital
- Hinduja Healthcare
- Surya Hospital

Schools: 5–15 min drive

- Poddar International School
- Maneckji Cooper Education Trust School
- Jamnabai Narsee International School
- Arya Vidya Mandir Santacruz School

15 min drive

- Chhatrapati Shivaji Maharaj International Airport
- Western Express Highway



Few of our Completed Projects



Poonam Chambers Worli, Mumbai



Everest Chambers Malabar Hill, Mumbai



Sky-Scraper Apartments Breach Candy, Mumbai



Ajanta Aparments Colaba, Mumbai



Pleasant Palace Walkeshwar, Mumbai



Manju Mahal Pali Hill, Bandra, Mumbai



Poonam's Building Juhu, Mumbai



Poonam Nagar Andheri East, Mumbai



Poonam Heights Goregoan West, Mumbai



Solitare Park Andheri East, Mumbai



Ekta Meadows (JV) Kandivali East, Mumbai



Villa Lonavala



Hotel King's International Juhu, Mumbai



Hotel Horizon Juhu, Mumbai



Hotel Poonam International Worli, Mumbai

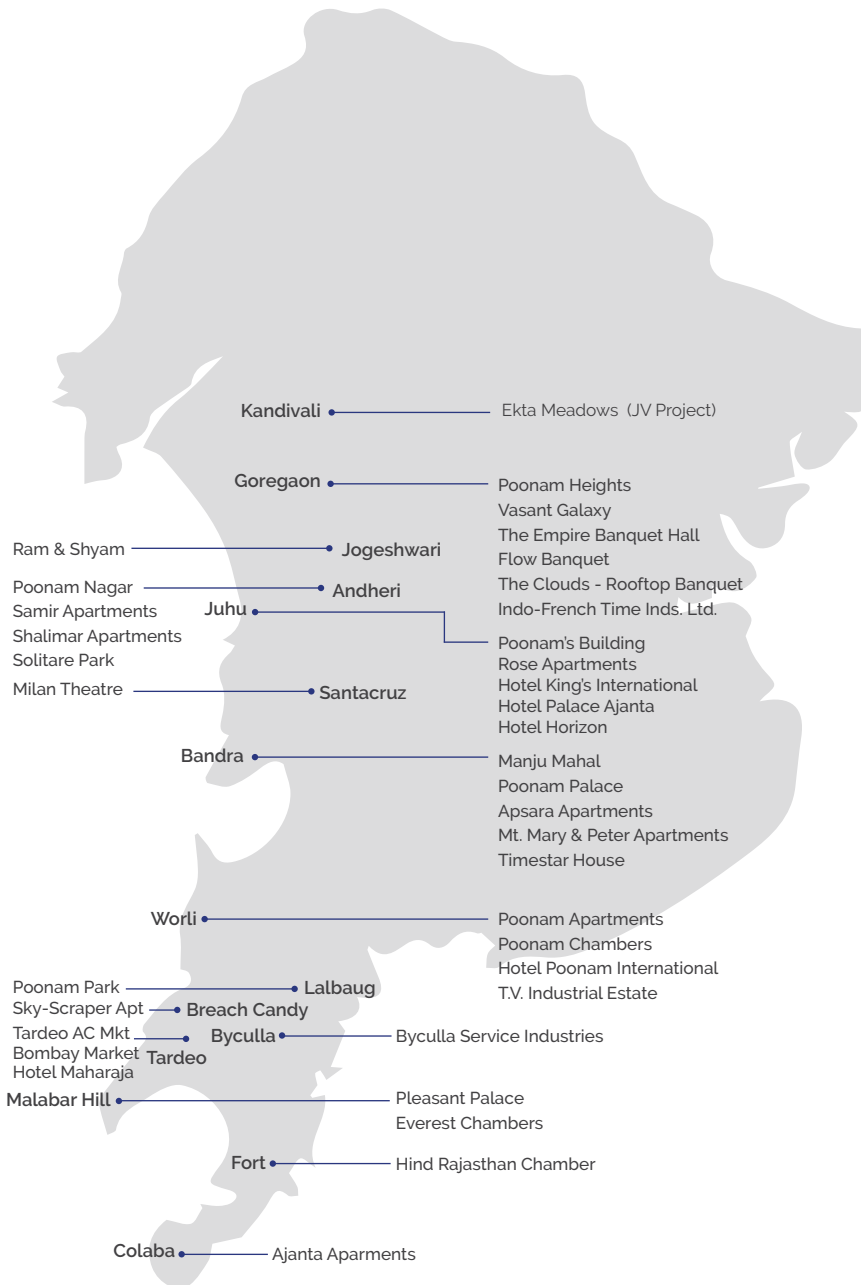

Building Legacies Across Mumbai Since 1960

For over six decades, Poonam Group has been a cornerstone of Mumbai's real estate, guided by the unwavering principle of "Quality Without Compromise." Founded in 1960 by Mr. Poonamchand Shah, our three-generation legacy is built on trust, innovation, and an enduring commitment to customer satisfaction. We don't just construct buildings; we craft spaces that redefine urban living and working environments across the Mumbai Metropolitan Region.

Our journey is marked by numerous landmark projects – including Poonam Chambers (Worli), Poonam Nagar (Andheri East), Poonam Heights (Goregaon West), Ekta Meadows is a joint venture project (Kandivali East), Pleasant Palace (Malabar Hill) and Poonams (Juhu) – representing just a glimpse of our extensive portfolio that stands as a testament to our expertise and dedication. Each development blends modern architecture with thoughtful design, reflecting our enduring commitment to excellence in the dynamic landscape of Mumbai.

With a legacy of delivering 15 million square feet our extensive experience provides us with a unique understanding of the global real estate landscape.

As we embark on a new chapter with exciting developments in Mumbai, our core values of meticulous planning, strategic foresight, and a dynamic team remain our driving force. Join us as we continue to shape the future of real estate, delivering unparalleled experiences and building a legacy of trust, one project at a time.



PR1180002501408
<https://maharera.mahaonline.gov.in>



Site Address: Armaan, Saraswat Road, Off, Linking Rd, Santacruz (West),
Mumbai 400054



POONAM GROUP

Builders & Developers

Head Office: Timestar House, 12 Udyog Nagar,
S. V. Road, Goregaon (W), Mumbai - 400062
+91 91520 18089 | +91 91520 18060



Project Funding by:



Sales Inquiries:
+91 98201 00062



Email:
info@poonamgroup.com



Web:
www.poonamgroup.com

Disclaimer: The layout plan, the number/orientation of buildings/towers/wings/structures, the common areas, facilities and amenities, the fixtures, fittings, soft furnishing / furniture, gadgets, technology, information, pictures, images and visuals, drawings, specifications, sketches and other details herein are merely a creative imagination and an Architect's impression and are only indicative. The plans, designs, and dimensions are as per current sanctioned plans and approvals. Specifications, amenities, and facilities will be as set out in the agreement for sale as uploaded on the RERA website (<https://maharera.mahaonline.gov.in>) under Registration No. PR1180002501408. The same may be subject to modification /change/revision/alteration in terms of approvals, orders, directions and/or regulations of the concerned / relevant authorities, and/or for compliance with laws/regulations in force from time to time and/or in line with our customer policies. We may modify/alter the above by following due procedure as prescribed under the Real Estate (Regulation and Development) Act, 2017, ("RERA") read with the provisions of the Maharashtra Real Estate (Regulation and Development) (Registration of real estate projects, Registration of real estate agents, rates of interest and disclosures on website) Rules, 2017 and the Rules and Regulations framed under RERA for Maharashtra ("RERA Rules"). Further, dimensions mentioned on the floor plans are as per the plans approved by the MCGM and the same are subject to construction exigencies. Minor Variations (+/-3%) in actual carpet areas may occur as a result of finishing tolerances & column projections.